



53212 Thrust ball bearings, single direction

- Popular item

Thrust ball bearings, single direction

Bearing data

[Tolerances,](#)
table 1

Bearing interfaces

[Seat tolerances for standard](#)
[conditions,](#)
[Tolerances and resultant fit](#)

Technical specification

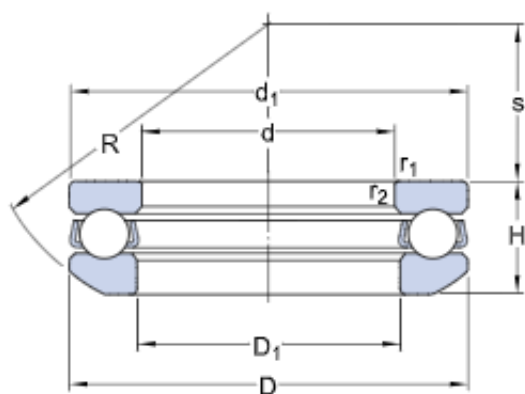

DIMENSIONS

d	60 mm	Bore diameter
D	95 mm	Outside diameter
H	28 mm	Height
H ₁	31 mm	Height bearing including seat washer
d ₁	≈ 95 mm	Outside diameter shaft washer
D ₁	≈ 62 mm	Inner diameter housing washer
D ₂	78 mm	Inner diameter sphered seat washer
D ₃	100 mm	Outside diameter sphered housing washer
C	9 mm	Height sphered housing washer
R	72 mm	Radius sphered housing washer
s	32.5 mm	Centre height housing washer sphere
r _{1,2}	min. 1 mm	Chamfer dimension washer

ABUTMENT DIMENSIONS

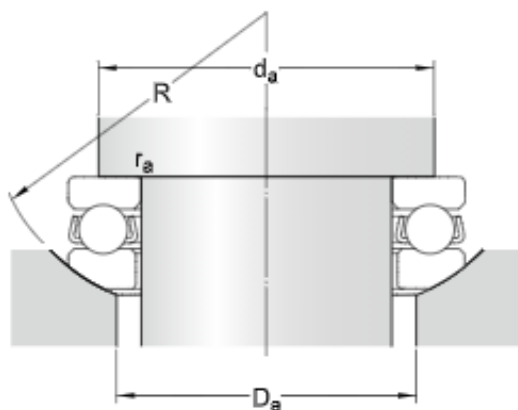

d_a min. 81 mm Abutment diameter shaft

D_a max. 78 mm Abutment diameter housing

r_a max. 1 mm Fillet radius



CALCULATION DATA

C	59.2 kN	Basic dynamic load rating
C_0	140 kN	Basic static load rating
P_u	5.1 kN	Fatigue load limit
	2 600 r/min	Reference speed
	3 600 r/min	Limiting speed
A	0.12	Minimum load factor

MASS

0.82 kg	Mass bearing (including seat washer where applicable)
---------	---

ASSOCIATED PRODUCTS